

D-UNC-Bumpers

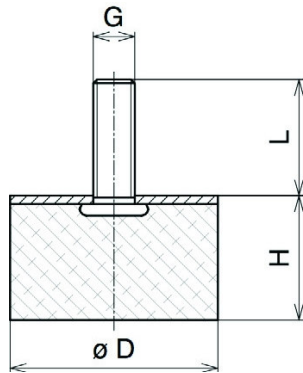

Part Number	Dia. x Height mm (Inch) (D) x (H)	Thread (G)	Length mm (Inch) (L)	Thickness mm (Inch) (S)	Quality NR ShoreA Duro	Compression				Shear			
						Max. Static Load		Spring Rate Ks		Max. Static Load		Spring Rate Ks	
						N	lbs	N/mm	lbs/in	N	lbs	N/mm	lbs/in
0703NU	7 x 3 (.28) x (.12)	UNC4-40	12 (.47)	1 (.04)	43	17	4	87	492	6	1	11	62
0703DU						31	7	161	910	11	2	20	115
0703PU						51	11	261	1475	18	4	33	186
0907NU	9 x 7 (.35) x (.28)	UNC8-32	12 (.47)	1 (.04)	43	17	4	28	158	6	1	6	34
0907DU						31	7	52	293	11	2	11	63
0907PU						51	11	84	475	18	4	18	102
1010NU	10 x 10 (.39) x (.39)	UNC8-32	10 (.39)	1 (.04)	43	18	4	21	119	6	1	5	28
1010DU						33	7	39	220	11	2	9	52
1010PU						54	12	63	356	18	4	15	85
1206NU	12 x 6 (.47) x (.24)	UNC8-32	10 (.39)	1 (.04)	43	39	9	81	458	13	3	13	73
1206DU						72	16	150	847	24	5	24	136
1206PU						117	26	243	1373	39	9	39	220
1320NU	13 x 20 (.51) x (.79)	UNC8-32	10 (.39)	1.5 (.06)	43	27	6	15	85	9	2	4	23
1320DU						50	11	28	157	17	4	7	42
1320PU						81	18	45	254	27	6	12	68
1506NU	15 x 6 (.59) x (.24)	UNC8-32	13 (.51)	1.5 (.06)	43	85	19	213	1204	28	6	25	141
1506DU						157	35	394	2227	52	12	46	261
1506PU						255	57	639	3611	84	19	75	424
1508NU	15 x 8 (.59) x (.31)	UNC8-32	13 (.51)	1.5 (.06)	43	61	14	102	576	20	4	17	96
1508DU						113	25	189	1066	37	8	31	178
1508PU						183	41	306	1729	60	13	51	288
1510NU	15 x 10 (.59) x (.39)	UNC8-32	13 (.51)	1.5 (.06)	43	51	11	64	362	17	4	13	73
1510DU						94	21	118	669	31	7	24	136
1510PU						153	34	192	1085	51	11	39	220
1513NU	15 x 13 (.59) x (.51)	UNC8-32	13 (.51)	1.5 (.06)	43	44	10	40	226	15	3	9	51
1513DU						81	18	74	418	28	6	17	94
1513PU						132	30	120	678	45	10	27	153
1515NU	15 x 13 (.59) x (.51)	UNC8-32	13 (.51)	1.5 (.06)	43	42	9	32	181	14	3	8	45
1515DU						78	17	59	335	26	6	15	84
1515PU						126	28	96	543	42	9	24	136
2010NU	20 x 10 (.79) x (.39)	UNC1/4-20	15 (.59)	2 (.08)	43	108	24	136	769	36	8	22	124
2010DU						200	45	252	1422	67	15	41	230
2010PU						324	73	408	2306	108	24	66	373

D-UNC-Bumpers

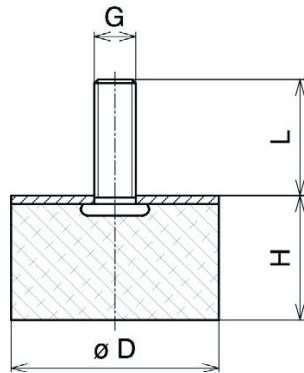

Part Number	Dia. x Height mm (Inch) (D) x (H)	Thread (G)	Length mm (Inch) (L)	Thickness mm (Inch) (S)	Quality NR ShoreA Duro	Compression				Shear			
						Max. Static Load		Spring Rate Ks		Max. Static Load		Spring Rate Ks	
						N	lbs	N/mm	lbs/in	N	lbs	N/mm	lbs/in
2013NU15	20 x 13 (.79) x (.51)	UNC1/4-20	15 (.59)	2 (.08)	43	89	20	81	458	30	7	16	90
2013DU15					57	165	37	150	847	56	12	30	167
2013PU15					68	267	60	243	1373	90	20	48	271
2015NU15	20 x 15 (.79) x (.59)	UNC1/4-20	15 (.59)	2 (.08)	43	82	18	63	356	27	6	14	79
2015DU15					57	152	34	117	659	50	11	26	146
2015PU15					68	246	55	189	1068	81	18	42	237
2020NU15	20 x 20 (.79) x (.79)	UNC1/4-20	15 (.59)	2 (.08)	43	73	16	40	226	24	5	10	57
2020DU15					57	135	30	74	418	44	10	19	105
2020PU15					68	219	49	120	678	72	16	30	170
2025NU15	20 x 25 (.79) x (.98)	UNC1/4-20	15 (.59)	2 (.08)	43	68	15	30	170	23	5	8	45
2025DU15					57	126	28	56	314	43	10	15	84
2025PU15					68	204	46	90	509	69	16	24	136
2510NU16	25 x 10 (.98) x (.39)	UNC1/4-20	16 (.63)	2 (.08)	43	201	45	251	1418	67	15	35	198
2510DU16					57	372	84	464	2624	124	28	65	366
2510PU16					68	603	136	753	4255	201	45	105	593
2513NU16	25 x 13 (.98) x (.51)	UNC1/4-20	16 (.63)	2 (.08)	43	159	36	145	819	53	12	25	141
2513DU16					57	294	66	268	1516	98	22	46	261
2513PU16					68	477	107	435	2458	159	36	75	424
2515NU16	25 x 15 (.98) x (.59)	UNC1/4-20	16 (.63)	2 (.08)	43	144	32	111	627	48	11	22	124
2515DU16					57	266	60	205	1160	89	20	41	230
2515PU16					68	432	97	333	1882	144	32	66	373
2517NU16	25 x 17 (.98) x (.67)	UNC1/4-20	16 (.63)	2 (.08)	43	132	30	85	480	44	10	18	102
2517DU16					57	244	55	157	889	81	18	33	188
2517PU16					68	396	89	255	1441	132	30	54	305
2525NU16	25 x 25 (.98) x (.98)	UNC1/4-20	16 (.63)	2 (.08)	43	113	25	49	277	38	9	12	68
2525DU16					57	209	47	91	512	70	16	22	125
2525PU16					68	339	76	147	831	114	26	36	203
3012NU19	30 x 12 (1.18) x (.47)	UNC5/16-18	19 (.75)	2 (.08)	43	280	63	280	1582	93	21	40	226
3012DU19					57	518	116	518	2927	172	39	74	418
3012PU19					68	840	189	840	4747	279	63	120	678
3015NU19	30 x 15 (1.18) x (.59)	UNC5/16-18	19 (.75)	2 (.08)	43	231	52	178	1006	77	17	31	175
3015DU19					57	427	96	329	1861	142	32	57	324
3015PU19					68	693	156	534	3018	231	52	93	526

D-UNC-Bumpers

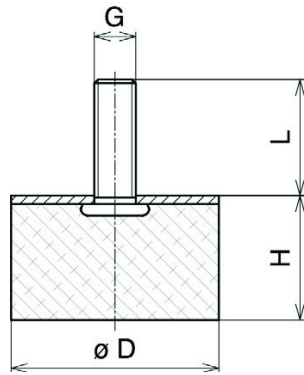

Part Number	Dia. x Height mm (Inch) (D) x (H)	Thread (G)	Length mm (Inch) (L)	Thickness mm (Inch) (S)	Quality NR ShoreA Duro	Compression				Shear			
						Max. Static Load		Spring Rate Ks		Max. Static Load		Spring Rate Ks	
						N	lbs	N/mm	lbs/in	N	lbs	N/mm	lbs/in
3020NU19	30 x 20 (1.18) x (.79)	UNC5/16-18	19 (.75)	2 (.08)	43	192	43	107	605	64	14	22	124
57					355	80	198	1119	118	27	41	230	
68					576	129	321	1814	192	43	66	373	
3030NU19	30 x 30 (1.18) x (1.18)	UNC5/16-18	19 (.75)	2 (.08)	43	162	36	58	328	54	12	14	79
57					300	67	107	606	100	22	26	146	
68					486	109	174	983	162	36	42	237	
4020NU22	40 x 20 (1.57) x (.79)	UNC5/16-18	22 (.87)	2 (.08)	43	401	90	223	1260	134	30	40	226
57					742	167	413	2331	248	56	74	418	
68					1203	270	669	3781	402	90	120	678	
4025NU22	40 x 25 (1.57) x (.98)	UNC5/16-18	22 (.87)	2 (.08)	43	349	78	152	859	116	26	31	175
57					646	145	281	1589	215	48	57	324	
68					1047	235	456	2577	348	78	93	526	
4028NU22	40 x 28 (1.57) x (1.10)	UNC5/16-18	22 (.87)	2 (.08)	43	330	74	127	718	110	25	28	158
57					611	137	235	1328	204	46	52	293	
68					990	223	381	2153	330	74	84	475	
4045NU22	40 x 45 (1.57) x (1.77)	UNC5/16-18	25 (.98)	2 (.08)	43	227	51	64	362	17	4	17	96
57					420	94	118	669	31	7	31	178	
68					681	153	192	1085	51	11	51	288	
5021NU25	50 x 21 (1.97) x (.83)	UNC3/8-16	25 (.98)	2 (.08)	43	732	165	407	2300	244	55	62	350
57					1354	304	753	4255	451	101	115	648	
68					2196	494	1221	6900	732	165	186	1051	
5028NU25	50 x 28 (1.97) x (1.10)	UNC3/8-16	25 (.98)	2 (.08)	43	588	132	235	1328	196	44	45	254
57					1088	245	435	2457	363	82	83	470	
68					1764	397	705	3984	588	132	135	763	
5030NU25	50 x 30 (1.97) x (1.18)	UNC3/8-16	25 (.98)	2 (.08)	43	564	127	209	1181	188	42	42	237
57					1043	235	387	2185	348	78	78	439	
68					1692	380	627	3543	564	127	126	712	
5040NU25	50 x 40 (1.97) x (1.57)	UNC3/8-16	25 (.98)	2 (.08)	43	488	110	132	746	163	37	30	170
57					903	203	244	1380	302	68	56	314	
68					1464	329	396	2238	489	110	90	509	
5050NU25	50 x 50 (1.97) x (1.97)	UNC3/8-16	25 (.98)	2 (.08)	43	449	101	96	543	150	34	24	136
57					831	187	178	1004	278	62	44	251	
68					1347	303	288	1628	450	101	72	407	

D-UNC-Bumpers

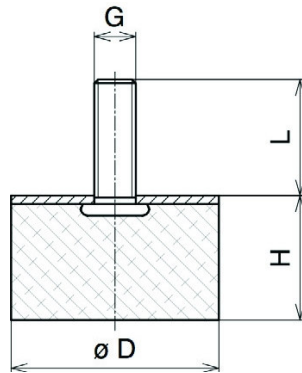

Part Number	Dia. x Height mm (Inch) (D) x (H)	Thread (G)	Length mm (Inch) (L)	Thickness mm (Inch) (S)	Quality NR ShoreA Duro	Compression				Shear			
						Max. Static Load		Spring Rate Ks		Max. Static Load		Spring Rate Ks	
						N	lbs	N/mm	lbs/in	N	lbs	N/mm	lbs/in
7525NU38	75 x 25 (2.95) x (.98)	UNC1/2-13	37 (1.46)	3 (.12)	43 57 68	1951	439	887	5013	650	146	115	650
7525DU38						3609	811	1641	9273	1203	270	213	1202
7525PU38						5853	1316	2661	15038	1950	438	345	1950
7540NU38	75 x 40 (2.95) x (1.57)	UNC1/2-13	37 (1.46)	3 (.12)	43 57 68	1334	300	361	2040	445	100	68	384
7540DU38						2468	555	668	3774	823	185	126	711
7540PU38						4002	900	1083	6120	1335	300	204	1153
7545NU38	75 x 45 (2.95) x (1.77)	UNC1/2-13	37 (1.46)	3 (.12)	43 57 68	1245	280	296	1673	415	93	60	339
7545DU38						2303	518	548	3095	768	173	111	627
7545PU38						3735	840	888	5018	1245	280	180	1017
7550NU38	75 x 50 (2.95) x (1.97)	UNC1/2-13	37 (1.46)	3 (.12)	43 57 68	1179	265	251	1418	393	88	54	305
7550DU38						2181	490	464	2624	727	163	100	565
7550PU38						3537	795	753	4255	1179	265	162	915
1030NU	100 x 30 (3.94) x (1.18)	UNC5/8-10	45 (1.77)	4 (.16)	43 57 68	3882	873	1493	8437	1294	291	172	972
1030DU						7182	1615	2762	15609	2394	538	318	1798
1030PU						11646	2618	4479	25312	3882	873	516	2916
1040NU	100 x 40 (3.94) x (1.57)	UNC5/8-10	45 (1.77)	4 (.16)	43 57 68	2928	658	813	4594	976	219	125	706
1040DU						5417	1218	1504	8500	1806	406	231	1307
1040PU						8784	1975	2439	13783	2928	658	375	2119
1050NU	100 x 50 (3.94) x (1.97)	UNC5/8-10	45 (1.77)	4 (.16)	43 57 68	2473	556	538	3040	824	185	97	548
1050DU						4575	1029	995	5625	1524	343	179	1014
1050PU						7419	1668	1614	9121	2472	556	291	1645
1060NU	100 x 60 (3.94) x (2.36)	UNC5/8-10	45 (1.77)	4 (.16)	43 57 68	2313	520	395	2232	738	166	80	452
1060DU						4279	962	731	4130	1365	307	148	836
1060PU						6939	1560	1185	6697	2214	498	240	1356
1250NU	125 x 50 (4.92) x (1.97)	UNC5/8-10	45 (1.77)	4 (.16)	43 57 68	4574	1028	1017	5747	1525	343	156	882
1250DU						8462	1902	1881	10632	2821	634	289	1631
1250DU						13722	3085	3051	17242	4575	1029	468	2645
1550NU	150 x 50 (5.91) x (1.97)	UNC5/8-10	45 (1.77)	5 (.20)	43 57 68	7649	1720	1700	9607	2550	573	224	1266
1550DU						14151	3181	3145	17773	4718	1061	414	2342
1550DU						22947	5159	5100	28821	7650	1720	672	3798
2050NU	200 x 50 (7.87) x (1.97)	UNC3/4-11	45 (1.77)	5 (.20)	43 57 68	18000	4047	4000	22605	6000	1349	400	2260
2050DU						33300	7486	7400	41819	11100	2495	740	4182
2050PU						54000	12140	12000	67815	18000	4047	1200	6781