

TYPE FBNC

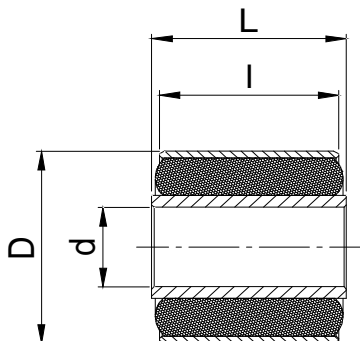

STANDARD 65 IRHD

Item	d	D	I	L	RADIAL		AXIAL		TORSIONAL		CONICAL	
					Stiffness (daN/mm)	Deflec.max (mm)	Stiffness (daN/mm)	Deflec.max (mm)	Stiffness (Nm/°)	Angle.max (°gradi)	Stiffness (Nm/°)	Angle.max (°gradi)
FBNC1027.1725	10,0	27,0	17,0	25,0	114	0,8	22	1,6	4,78	30°	2,54	3°
FBNC1028.4045	10,0	28,0	40,0	45,0	423	0,8	56	1,0	1,18	25°	5,62	2°
FBNC1030.2567	10,0	30,0	25,0	67,5	218	0,8	36	8,5	9,60	30°	1,10	7°
FBNC1225.4550	12,0	25,0	45,0	50,0	2436	0,5	145	1,0	2,28	20°	37,82	1°
FBNC1230.3642	12,0	30,0	36,0	42,0	414	0,8	55	1,2	1,42	30°	4,40	2°
FBNC1430.4451	14,3	30,0	44,5	50,8	1088	0,7	97	1,3	2,49	25°	17,12	2°
FBNC1632.7076	16,0	32,0	70,0	76,0	3036	0,7	192	1,2	5,15	20°	118,59	1°
FBNC1741.3538	17,0	41,0	35,0	38,0	290	1,2	50	0,6	2,58	30°	3,04	7°
FBNC1834.3033	18,0	34,0	30,0	33,0	970	0,6	86	0,6	3,19	20°	6,64	3°
FBNC1836.4045	18,0	36,0	40,0	45,0	1366	0,7	112	1,0	4,53	20°	17,09	1°
FBNC2052.8086	20,0	52,0	80,0	86,0	841	1,5	108	1,2	8,65	20°	25,68	1°
FBNC2240.4045	22,0	40,0	40,0	45,0	2186	0,6	149	1,0	7,11	20°	26,85	3°
FBNC2448.4044	24,0	48,0	40,0	44,0	705	1,1	85	0,8	6,38	30°	9,23	7°
FBNC2456.7085	24,0	56,0	70,0	85,0	1351	1,4	142	3,0	13,94	20°	55,62	2°
FBNC2460.7275	24,0	60,0	72,0	75,0	938	1,7	120	0,6	13,46	20°	42,10	2°
FBNC3252.6066	32,0	52,0	60,0	66,0	4854	0,8	274	1,2	21,40	20°	136,73	3°
FBNC3864.7075	38,0	64,0	70,0	75,0	4474	1,0	280	1,0	33,16	20°	173,64	3°
FBNC4075.5770	40,0	75,0	57,0	70,0	1282	1,5	142	2,6	27,57	25°	34,80	3°
FBNC4082.8288	40,0	82,0	82,0	88,0	3544	1,4	272	1,2	60,10	20°	195,00	3°
FBNC4082.8696	40,0	82,2	86,0	96,0	3780	1,4	285	2,0	62,73	20°	228,90	1°
FBNC4082.9098	40,0	82,0	90,0	98,0	4226	1,4	306	1,6	66,11	20°	279,77	1°
FBNC5093.122134	50,0	93,0	122,0	134,0	32029	2,2	268	2,4	73,19	15°	351,77	1°